

Sliding/tilting roof

Sliding/tilting roof - exploded view Glass panel 04.94 ä

1. Frame

- ◆ Removing and installing only possible with moulded headliner removed => Page [70-31](#)

2. Cover

3. Combi screw - 3 Nm

- ◆ 3 off

4. Sliding roof motor

- ◆ Only remove and install in zero position.

5. Draught deflector

- ◆ Removing => Page [60-21](#)

6. Guide profile

- ◆ Remove in order to remove guide plate.

7. Countersunk screw - 2 Nm-

- ◆ 3 off

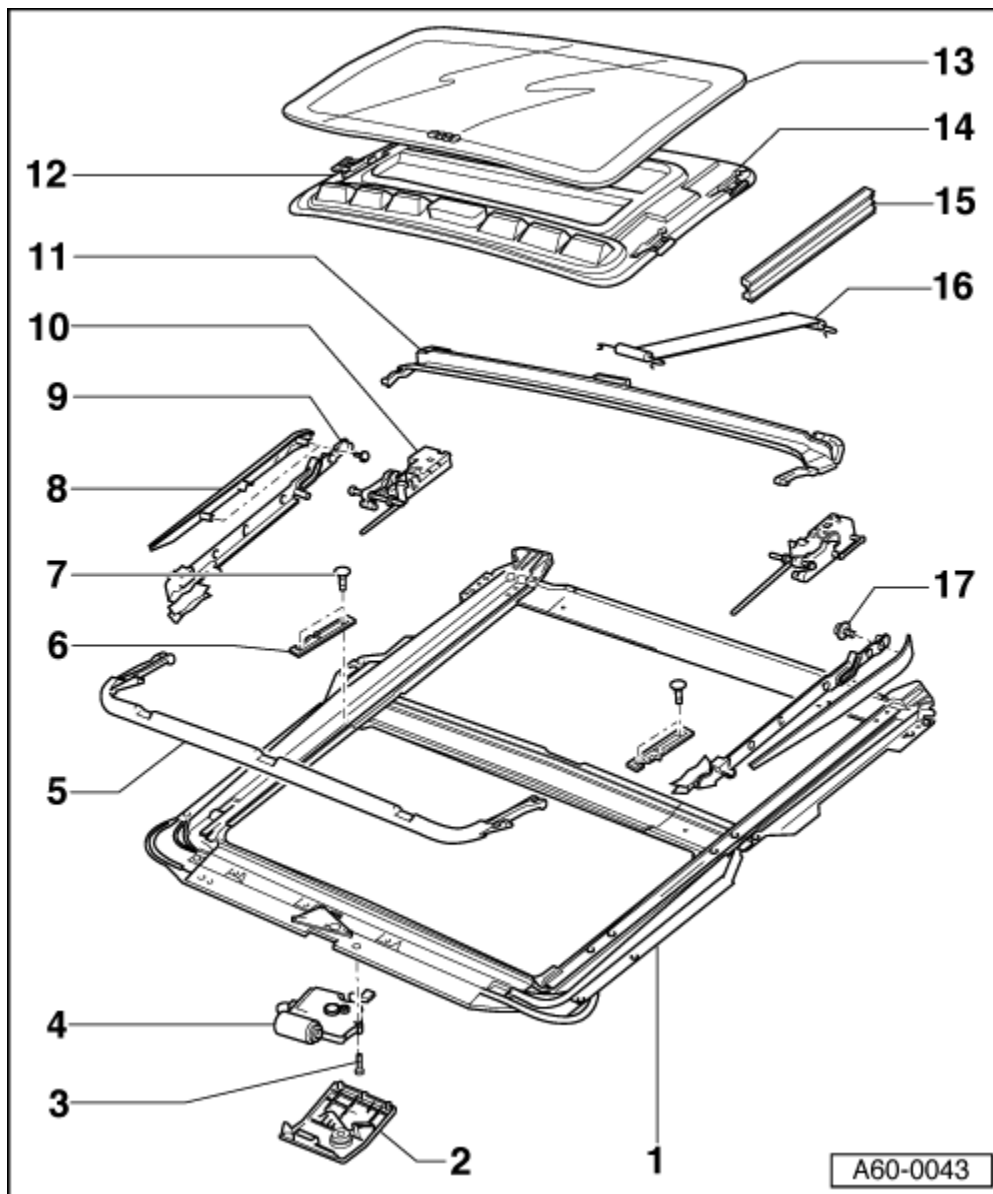

8. Cover

- ◆ To adjust, tilt sliding/tilting roof panel and press cover upwards against panel seal. Tighten screws, - item 14- to 1 Nm.

9. Guide plate

- ◆ Removal
=> Page [60-23](#).
- 10. Rear locator with cable**
 - ◆ To remove, remove sliding/tilting roof panel => Page [60-5](#) and remove guide profile -item 6-.
- 11. Rain channel**
 - ◆ Removal
=> Page [60-22](#).
- 12. Sliding roof headliner**
 - ◆ Removal
=> Page [60-29](#).
- 13. Glass panel**
 - ◆ Removal
=> Page [60-28](#).

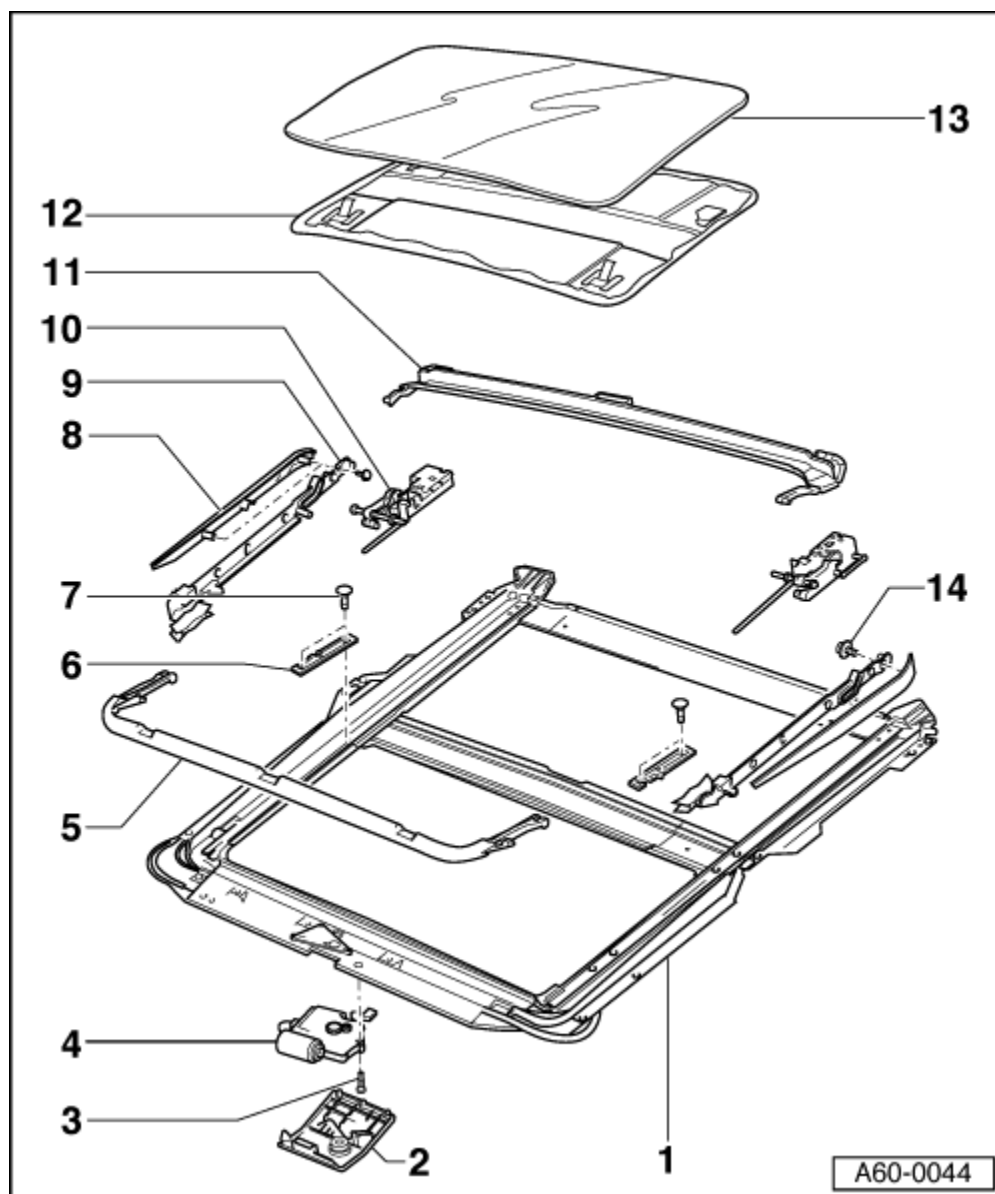

- 14. Slider**
 - ◆ To remove, pull out of clips on sliding roof headliner.
- 15. Cover**
 - ◆ Removing
=> Page [60-28](#)
- 16. Arrester**
 - ◆ No spare part
 - ◆ Installation
=> Page [60-29](#).
- 17. Oval-head screw**

