

Sliding/tilting roof

Removing and installing frame

1. Frame

Note:

- ◆ A second fitter is required for the removal of the frame.
- ◆ Removal:
 - ◆ Headliner removed => Page [70-31](#).
 - ◆ Sliding roof panel removed.
 - ◆ Sliding roof motor removed.
 - Detach rear water drainage tubes.
 - Unscrew hexagon nuts -2- from rear towards front.
 - Lower frame slightly, detach the front water drainage tubes and remove the frame from the vehicle.
- ◆ Installation:
 - Before installation, loosen screws -4- at angle bracket -3-.
 - Lift the frame onto the roof reinforcing frame and connect the front water

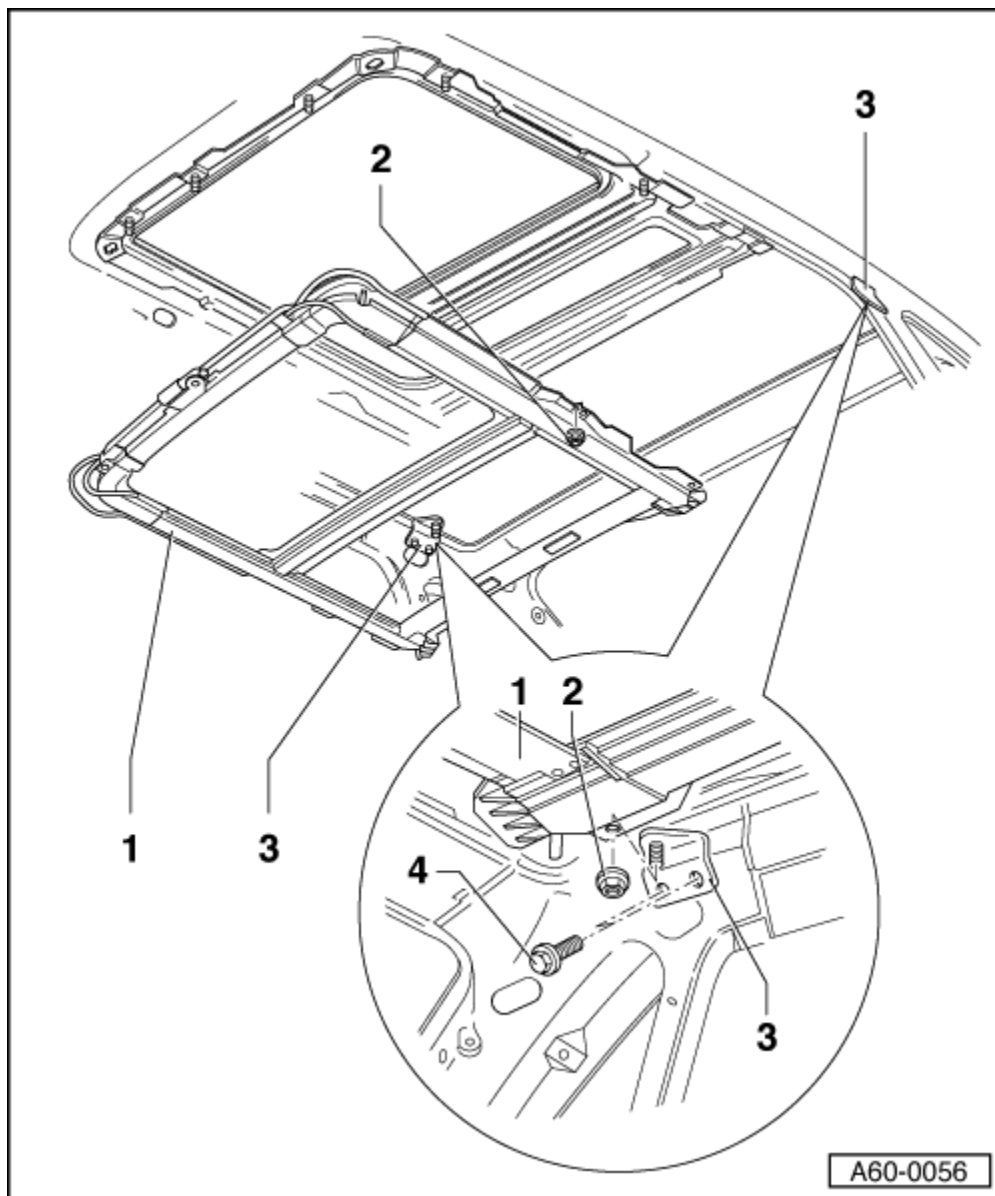

drainage
tubes.

- Centre the frame on the reinforcing frame and tighten the hexagon nuts -2- starting at the front towards the rear.
- Connect the rear water drainage tubes and tighten the hexagon screws -4-.

2. Hexagon nut

◆ 8 Nm

3. Angle bracket

- First fasten to roof frame with hexagon screws -4-, then to frame with hexagon nuts -2-.

4. Hexagon screw

◆ 8 Nm

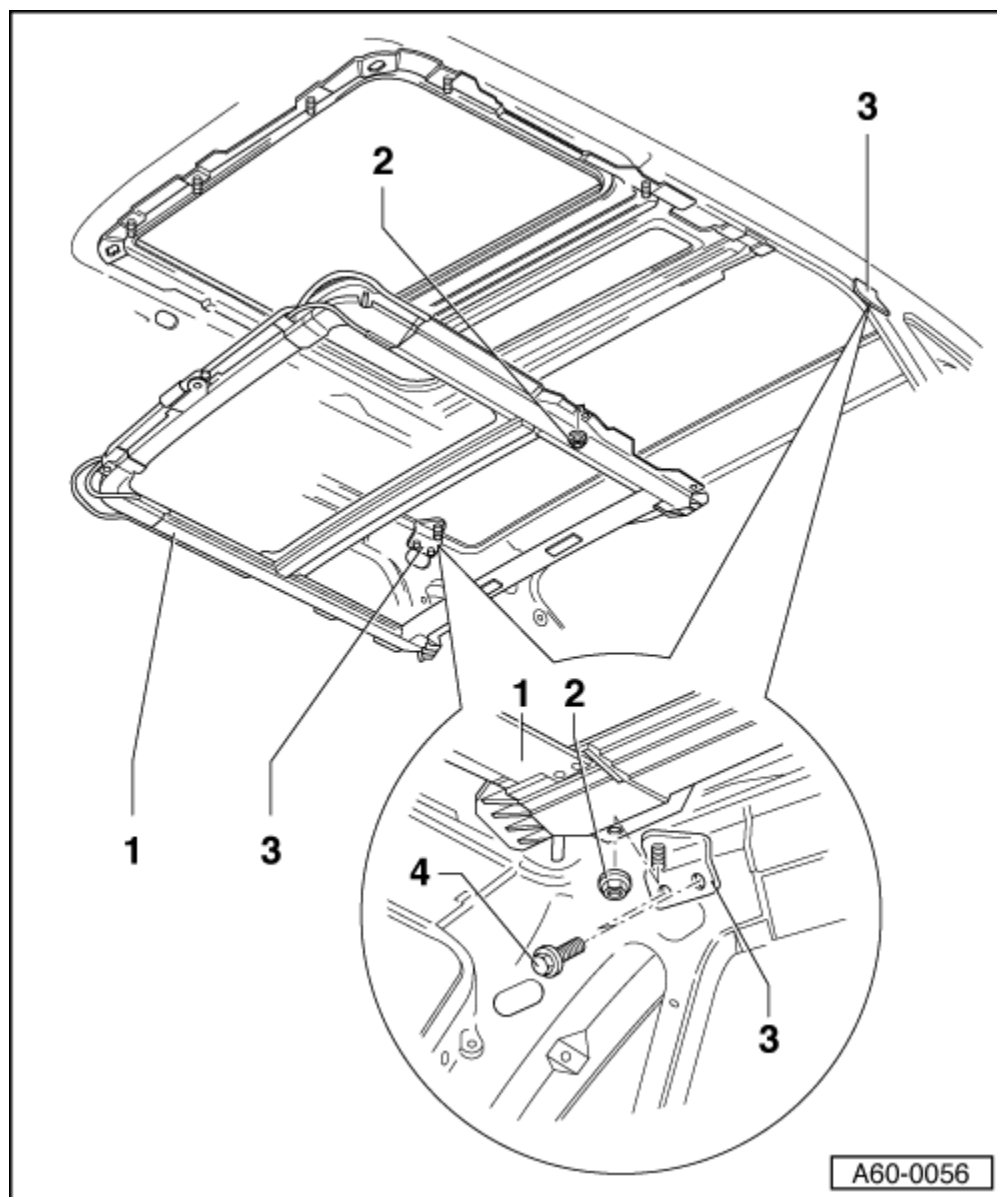

A60-0056