

Fuel supply system - Front-wheel drive

Dismantling fuel delivery unit - 4 and 6-cyl. engine (code letters AAH, ABC, ABK, ACK, ACZ, ADA, ADR, ADW, AEJ)

- ┌ Inner part of baffle housing
- ┌ Fuel pump
 - ┌ ♦ Different versions (Bosch or VDO)
 - ┌ ♦ Removing and installing => Fig. [20-71](#)
 - ┌ ♦ Pre-assembly => Page [20-69](#)
 - ┌ ♦ Electrical checking => Page [20-25](#)
 - ┌ ♦ Checking holding pressure

=> [Injection and Ignition System; Repair Group 24](#)

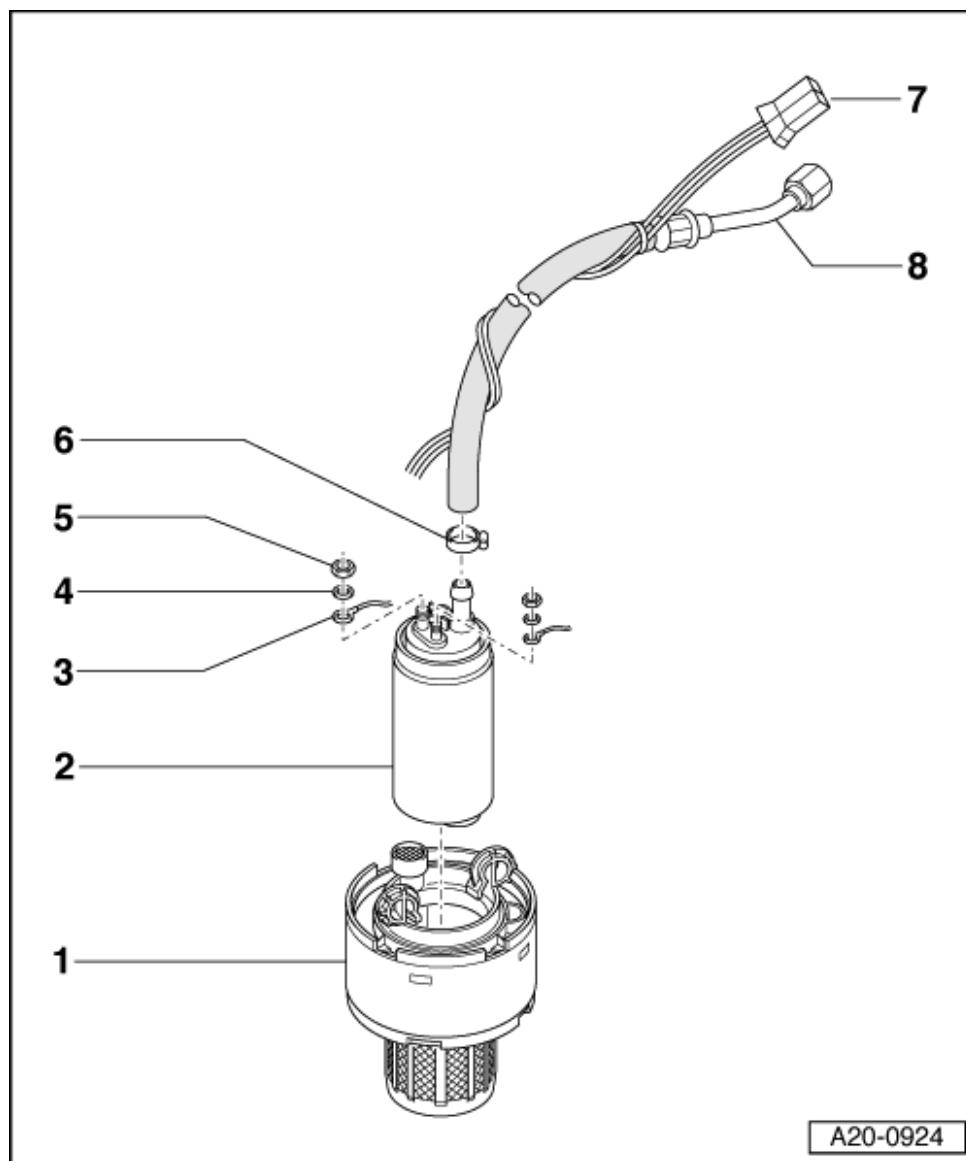

- ┌ Wire
 - ┌ ♦ For fuel pump
- ┌ Washer
- ┌ M4 = 1.1 Nm
M5 = 1.6 Nm
- ┌ Hose clamp
 - ┌ ♦ Use V.A.G 1275 to secure
- ┌ Wire
 - ┌ ♦ For fuel pump
 - ┌ ♦ Installation

- position =>
 Page [20-70](#)
- i Fuel supply pipe
 - i ♦ Fuel pump/sender housing
 - i ♦ Pre-assembly =>
 Page [20-69](#)

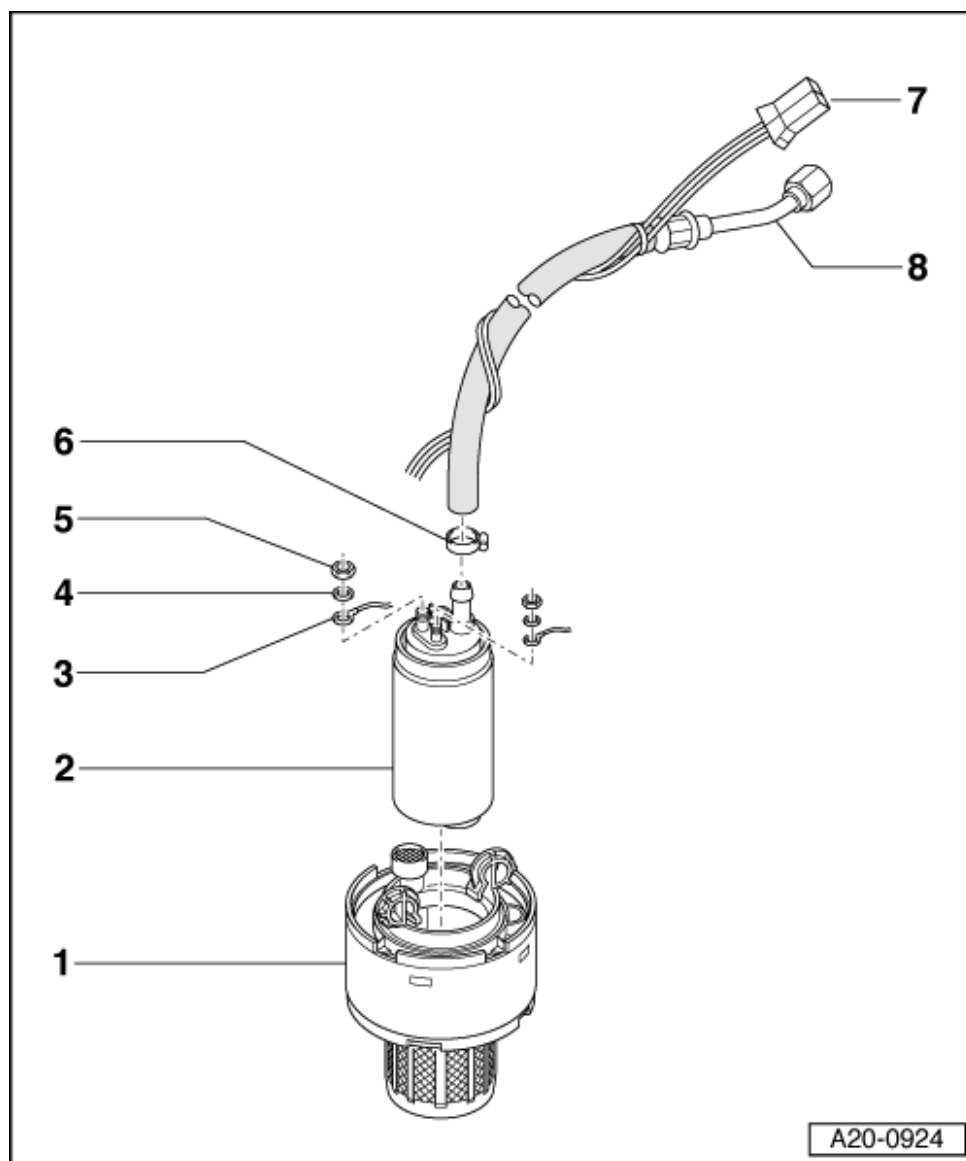

A20-0924

Pre-assembling fuel pump
 (Bosch) and fuel supply
 pipe

- i - Fit fuel supply pipe -2- with new tab-type hose clamp -4- at fuel pump -1- as shown.
- i - To do so, align fuel supply pipe such that white stripe -arrow 5- at fuel supply pipe coincides with electrical connections.

- i - Align tab-type hose clamp at an angle of $\alpha = 45^\circ$ to connection.
- i - Use V.A.G 1275 to secure tab-type hose clamp.
 - i - $c = 3 \text{ mm}$

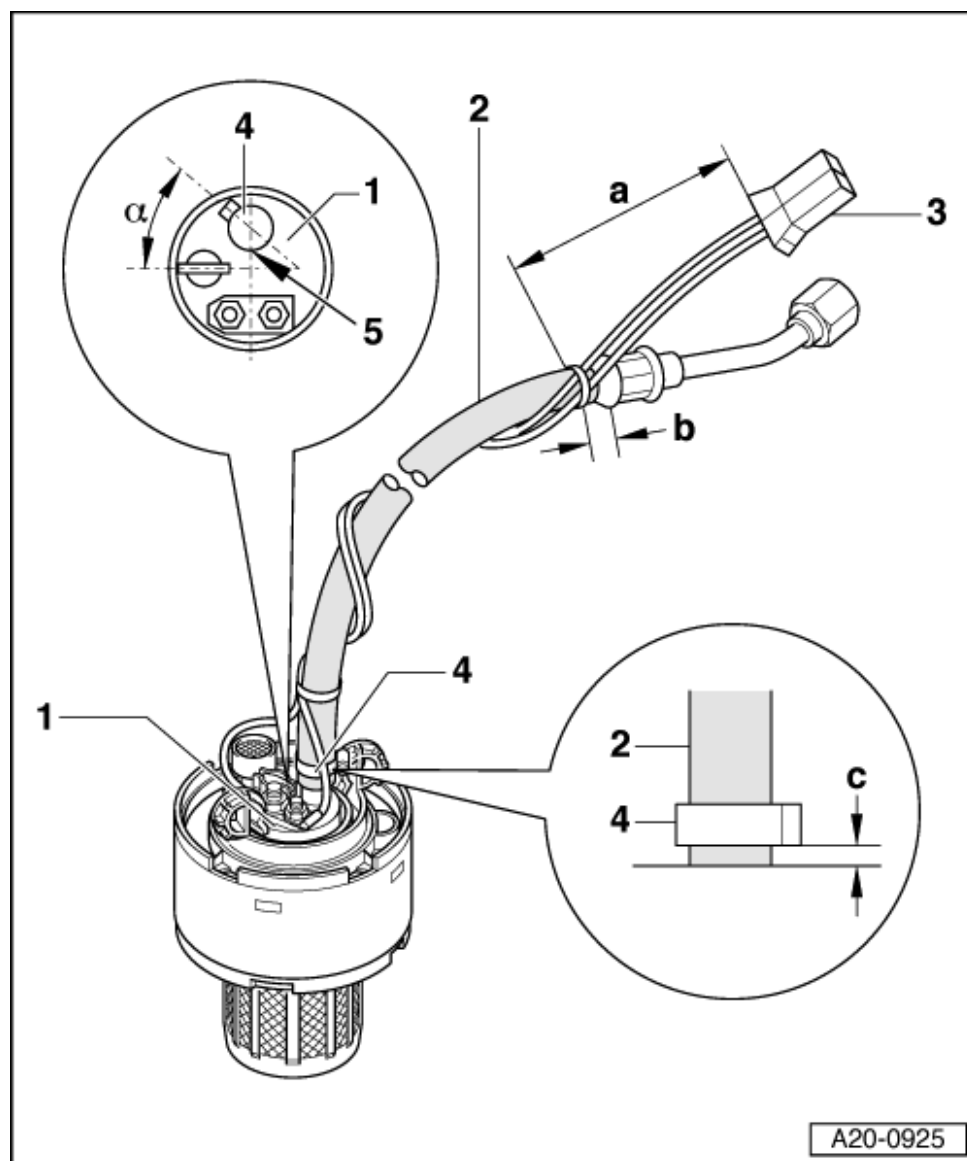

- i - Wind wiring -3- to fuel pump around fuel supply pipe.
- i - Secure wiring with fuel-resistant cable tie at marked location.
 - i - $a =$
Effective wire length 180 mm
 - i - $b = 5 \text{ mm}$

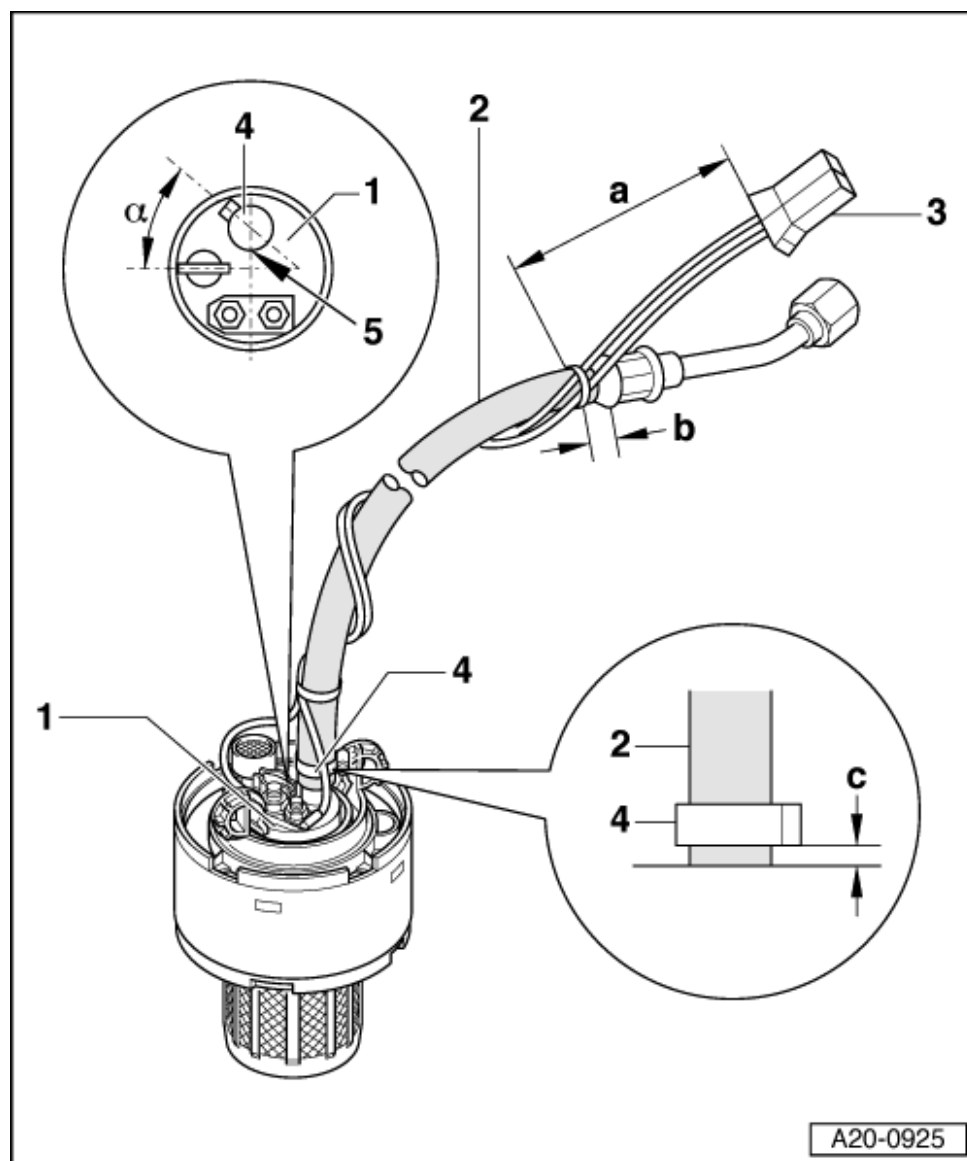

A20-0925

Pre-assembling fuel pump (VDO) and fuel supply pipe

- 1 - Fit fuel supply pipe -2- with new tab-type hose clamp -4- at fuel pump -1- as shown.
- 1 - To do so, align fuel supply pipe such that white mark -arrow 5- at fuel supply pipe is at an angle of $\beta = 10^\circ$ to electrical connections.

- i - Align tab-type hose clamp at an angle of $\alpha = 45^\circ$ to connection.
- i - Use V.A.G 1275 to secure tab-type hose clamp.
 - i - $c = 5 \text{ mm}$

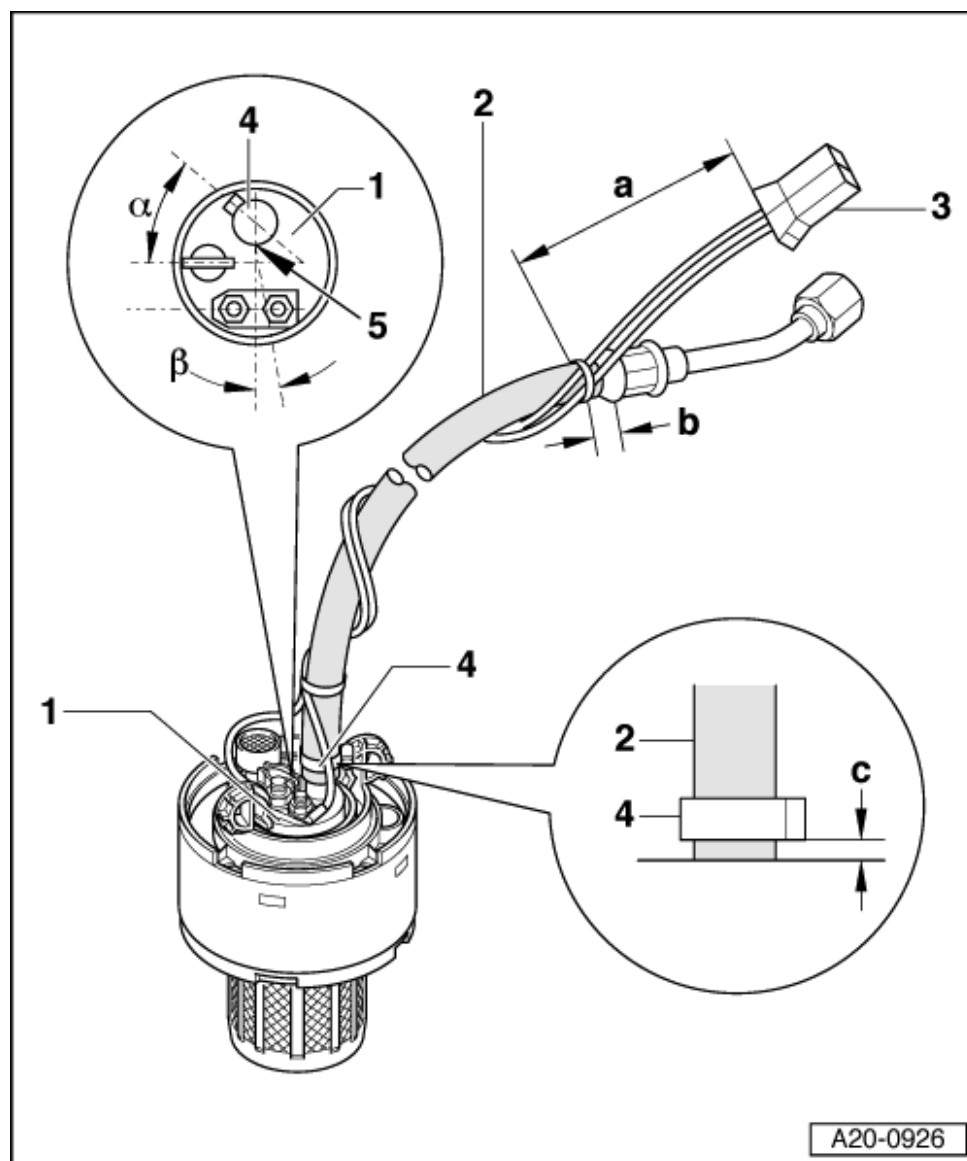

- i - Wind wiring -3- to fuel pump around fuel supply pipe.
- i - Secure wiring with fuel-resistant cable tie at marked location.
 - i - $a =$
Effective wire length 170 mm
 - i - $b = 5 \text{ mm}$

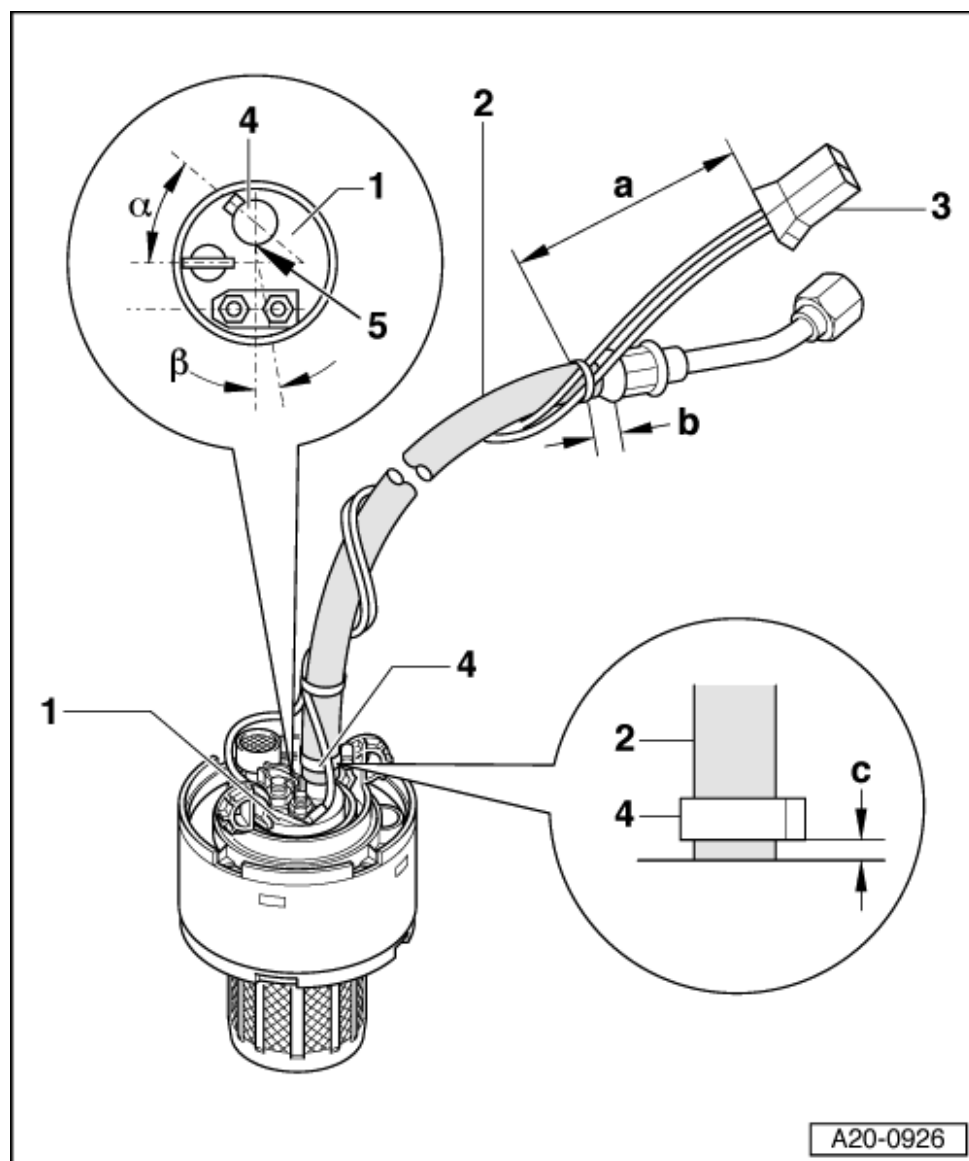

→ Fig.1 Removing and installing fuel pump (Bosch and VDO)

- Fuel delivery unit dismantled

Removing

- Use screwdriver to press both locking lugs at baffle housing outwards and at the same time pull fuel pump slightly upwards to prevent re-engagement of locking lugs.
- Repeat procedure at second shoulder of fuel pump.
- Twist fuel pump and pull it upwards out of baffle housing.

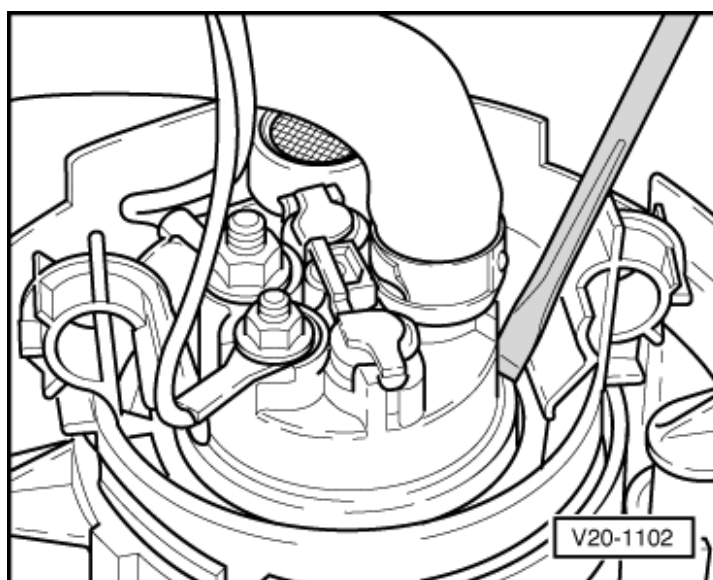

Installing

Install in reverse order, paying attention to the following:

- 1 ♦ Installation position: Offset connection at bottom of fuel pump must be inserted in hole in inner part of baffle housing